

CARE AND MAINTENANCE CLEANING INSTRUCTIONS

- ① To keep your PET Felt looking its best, occasional maintenance can be helpful. In order to remove dust, we recommend you to vacuum the PET Felt occasionally.

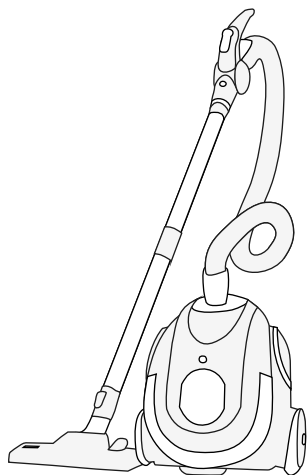

- ② Due to its porous structure, PET Felt can be easily cleaned with water. In most cases, water is sufficient to remove stains and will not damage the material. Avoid using cleaning products, as they may affect the surface.

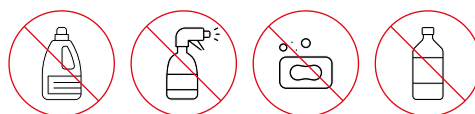
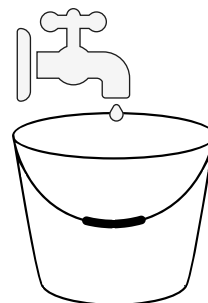

- ③ It is advised to dab it with a dry cloth while the PET Felt is still wet. **Do not rub!** Rubbing can damage the material.

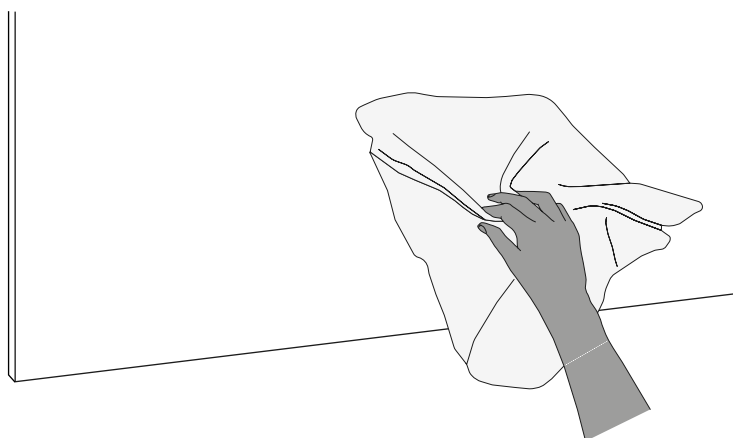

- ④ Let the panel rest until it is dry, and repeat the process if needed.

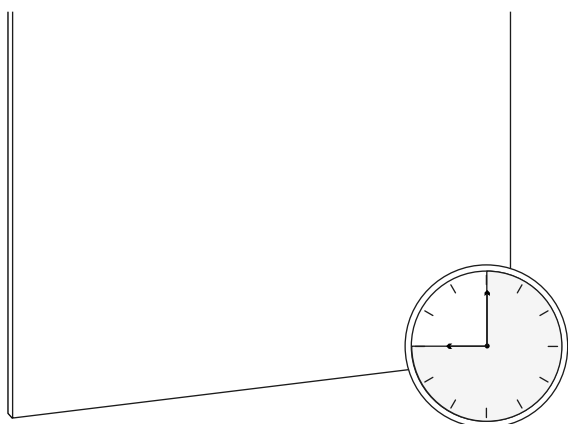

- ⑤ If water is not sufficient, difficult stains can be removed with qualitative cleaning products like the James Cleaning set. It is advised to try a cleaning product out on a inconspicuous place prior to application on a visible area.

Depending on the type of stain, the James Cleaning set provides different solutions. Please read the James Cleaning manual to choose the correct treatment for each stain.

For more information contact our sales team:

T +31 (0) 262 062 102

E sales@refelt.nl