

RE:FELT

# ACOUSTIC PET FELT PANELS INSTALLATION GUIDE



## TOOLS

---

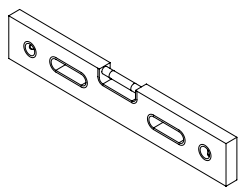

Level

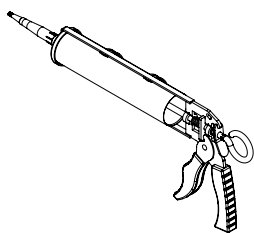

Glue gun

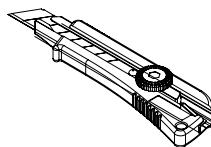

Snap-off  
blade cutter

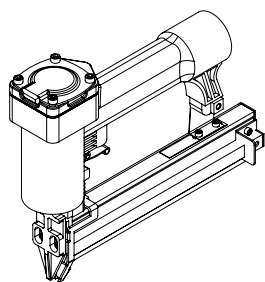

Nail gun

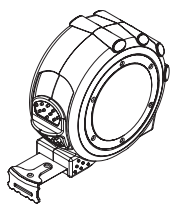

Measuring  
tape

## PANELS

---

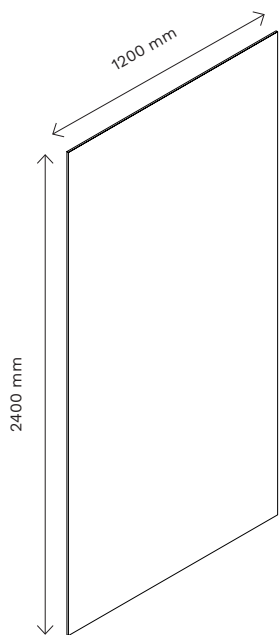

9 mm panels  
Standard Collection

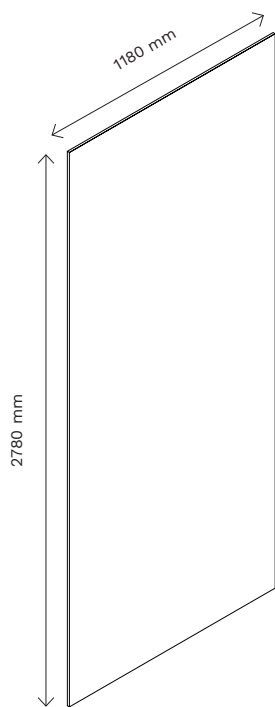

12 mm panels  
Melange Collection

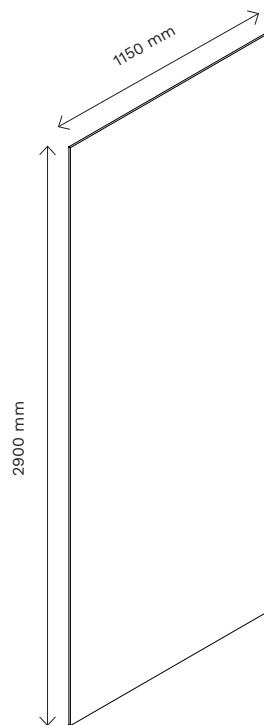

9 mm panels  
Refined Collection



Please note that there may be minor discrepancies in stated size.

## BEFORE YOU BEGIN

---

Since PET Felt panels are made of recycled material, they may have slight colour differences.

To keep the colour differences to a minimum, we advise installing the panels in the same order as stacked in a box, keeping the top of the panel as the front side.

The panels have a frontside and a backside, since the fibers are differently orientated on each side (nap direction). Keep in mind to apply the panels in the same direction and use the same side during the installation to avoid alterations in appearance.

PET Felt panels should be handled carefully during transportation and unloading. The dimensions and flexibility of a single panel usually require two people to lift it.

To achieve the most seamless transition between the panels, it is important to place them tightly against each other. You can do this by firmly pressing a loose panel against the already installed part before attaching it.

# INSTALLATION ORDER

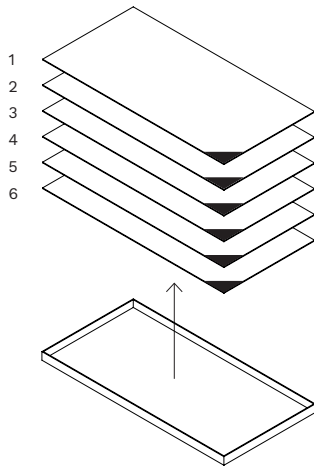

! De achterzijde van het paneel is aangegeven met een sticker.

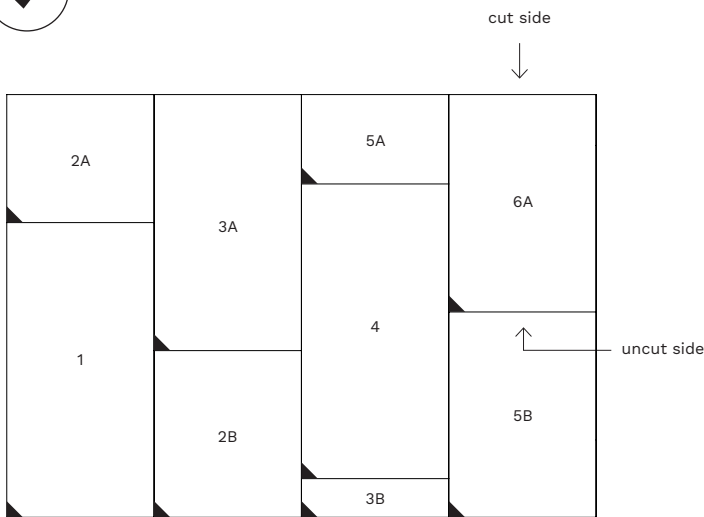

If you need to stack the panels, we advise you to use the pattern as shown here. An asymmetric pattern ensures that the colour differences are less visible. Always place the cutting side on the outside (ceiling or floor side).

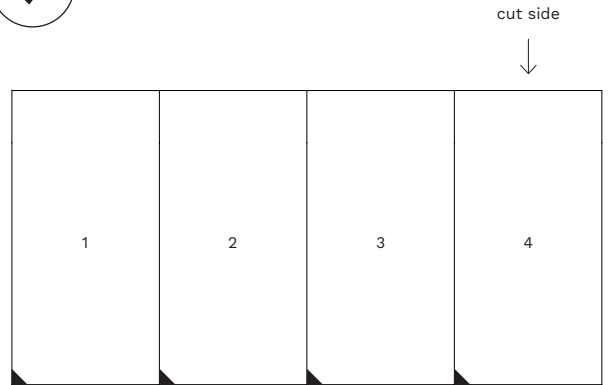

If you create a single row, make sure to install the panels in the same order as stacked in a box to avoid colour differences. In case of cutting the panels to size, place the cutting side on the ceiling side.

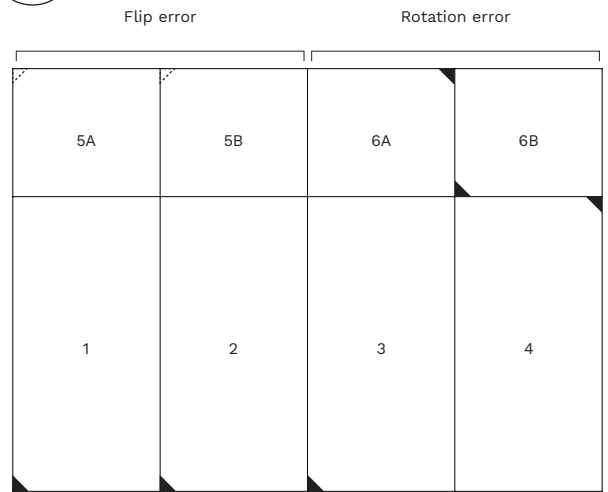

Never use one panel to fill the missing smaller pieces. We advise cutting / installing the panels in the same order as stacked in a box to avoid colour differences.

## CUTTING PANELS TO SIZE

PET Felt panels can be cut using a blade cutter.

Smaller, tailor-made cut-outs and alterations can be made on-site with a snap-off blade cutter and a ruler.

You can draw the reference markings for the cutting lines on the backside of the panel.

## INSTALLATION USING ADHESIVE

- ① Prepare the surface by making sure it is flat and free from dust and grease.

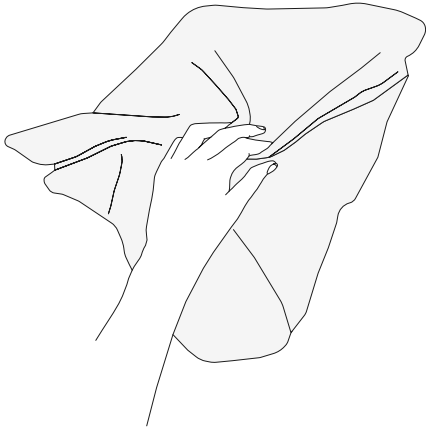

- ② Apply the adhesive on the backside of the panel following the manufacturer's instructions.

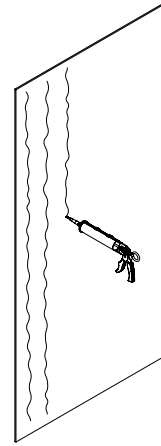

- ③ Mount the panels by placing the panels against the surface, starting at the bottom. Make sure it is properly aligned, you can use a level to check that.

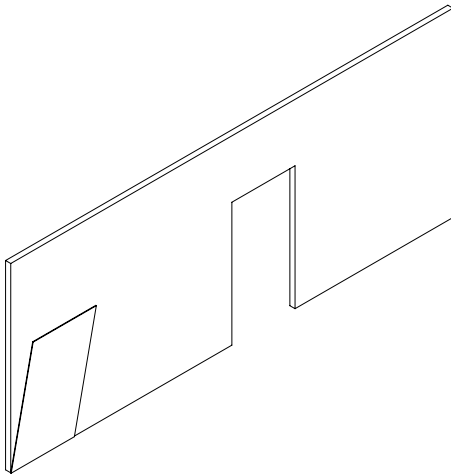

- Press the panel firmly against the surface, making sure that corners and edges are properly attached. Repeat these steps until the installation is complete.

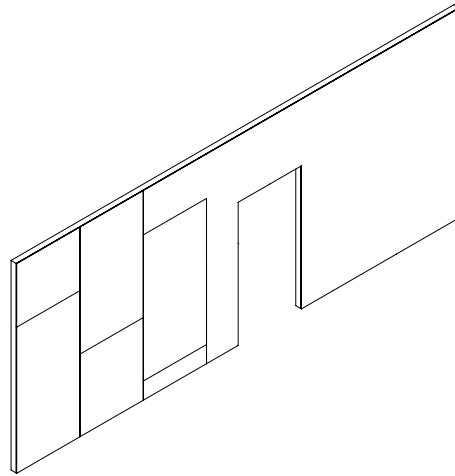

- ④ Allow the adhesive to cure. The curing time may vary, follow the adhesive manufacturer's instructions.

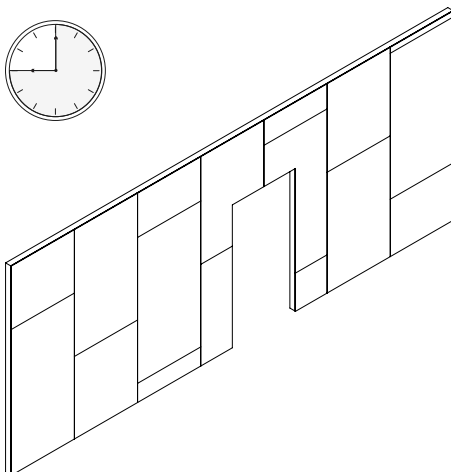

## INSTALLATION USING A NAIL GUN

- 1 Prepare wooden framework. This is necessary if you install the panels using a nail gun.

Make sure the frame is levelled. You can use a level to check that.

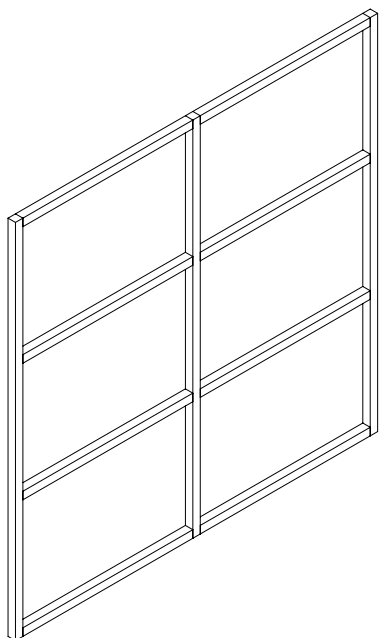

- ! To achieve higher acoustic performance you can fill the framework with insulation material.

- 2 Install the panels. Test the pressure of the nail gun and adjust it, so that the nails don't go too deep into the material.

For better grip of the headless nail, the nails should be applied at an angle of approximately 45°.

